

Challenges

There is a new addition to the BBO software – The Challenge. This can be found in the Competitive area under the heading Other Competitive Games – Challenges.

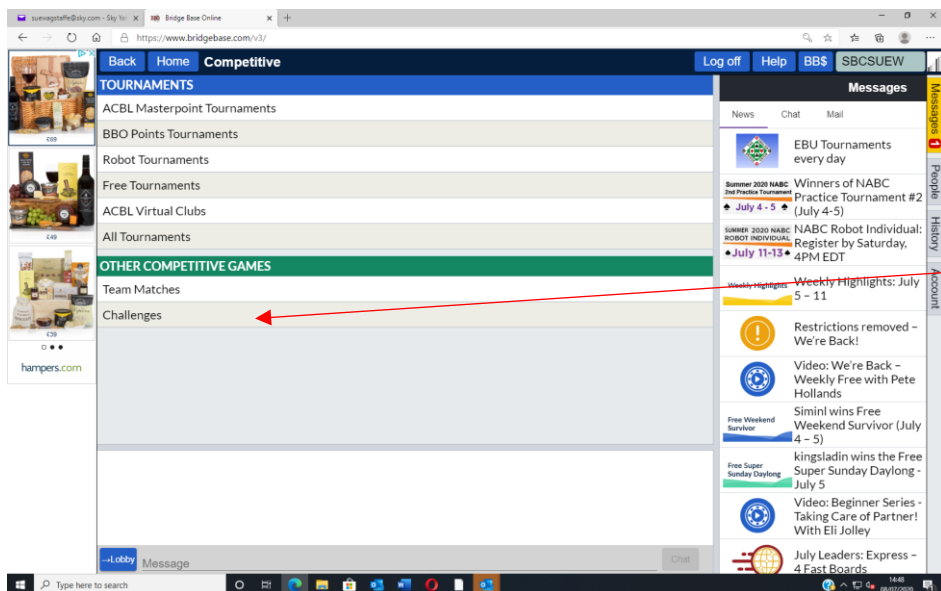
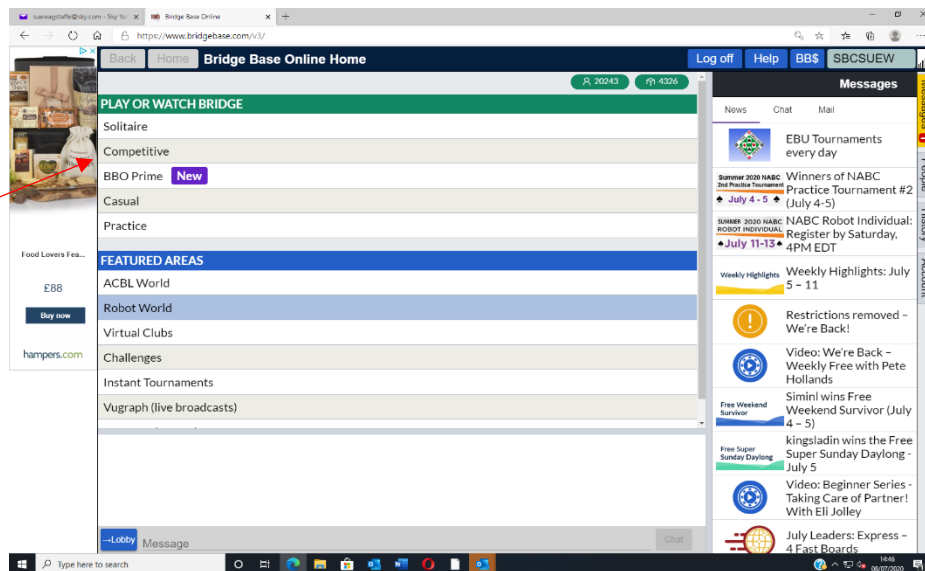

You can challenge friends, strangers, robots or a group of friends but many of these challenge formats involve bidding as well as playing and this is not ideal as the BBO robots do not play Acol.

The two challenge formats which best meet our needs are:

1. **Challenge a Robot** (no charge) – the Just Declare button should be ticked to ensure no bidding

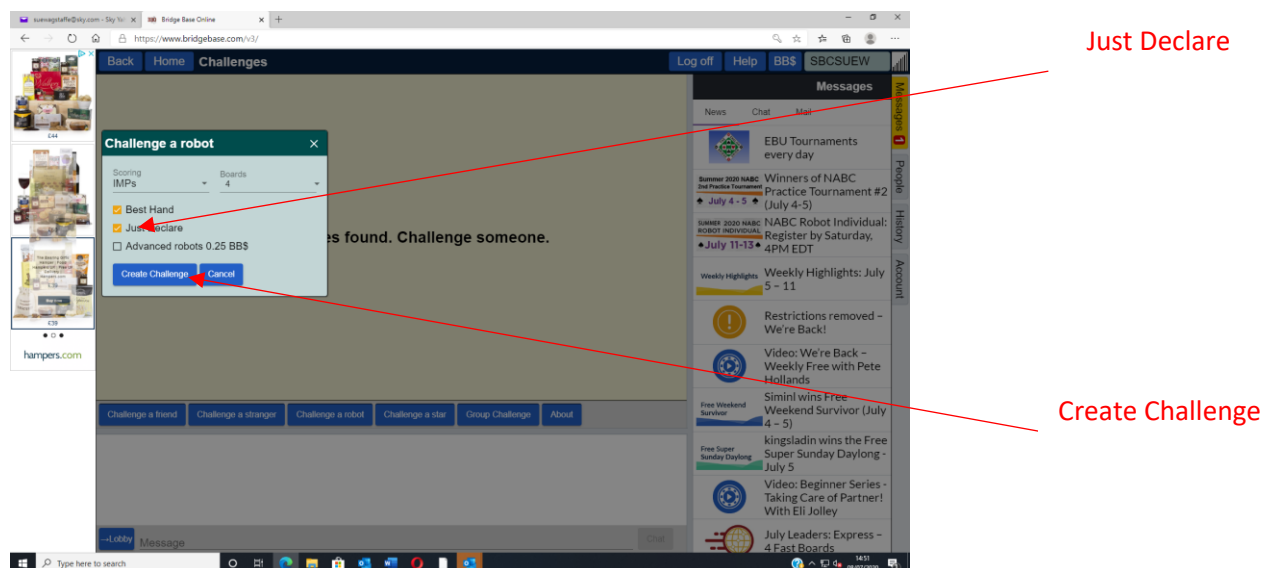

Then press Create Challenge. A box will appear on the top of the page with a green dot – IMPS challenge match against a robot – just declare - click on that bar

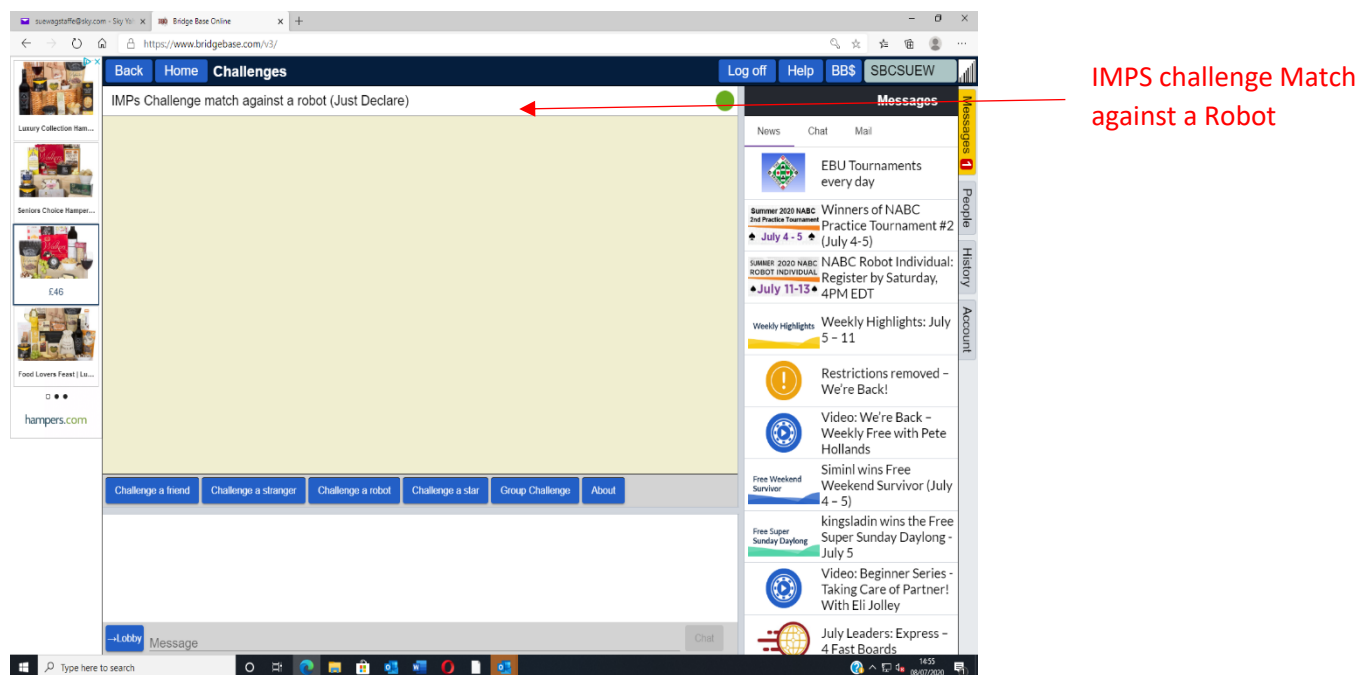

The screen will go dark and you will be invited to Play now. Click on here and you will get 4 boards to play at the end of which it will show you how you did in

comparison with the robot! (4 boards is the default – you can change it if you want a longer game)

2. The Group Challenge where you can challenge up to 4 other players – again make sure when you set it up that the Just Declare button is ticked to remove the need to bid from the game

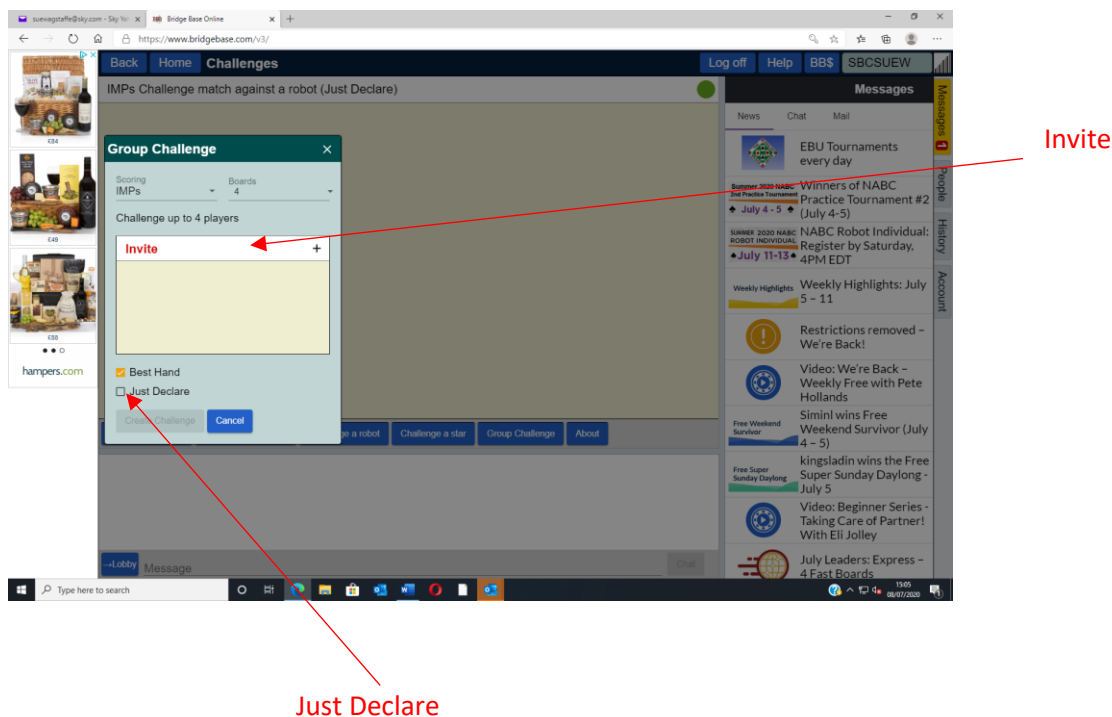

When you press on invite you will be allowed to invite up to 4 people to participate in the challenge. Using their BBO user names. You can also select how many boards the challenge is over. The default is 4 – but it can easily be changed to 8 or even more as you wish.

The challenge has a fixed time that it has to be played within but each participant can play at any time to suit them within the challenge window.

At the end of the challenge time the comparative results will appear in your mail and in your Tournament History

How do you know if someone has challenged you? The Features area in the Main Lobby will highlight the Challenges Bar in yellow and there will be a number after the word challenges – that tells you how many challenges have been made for you

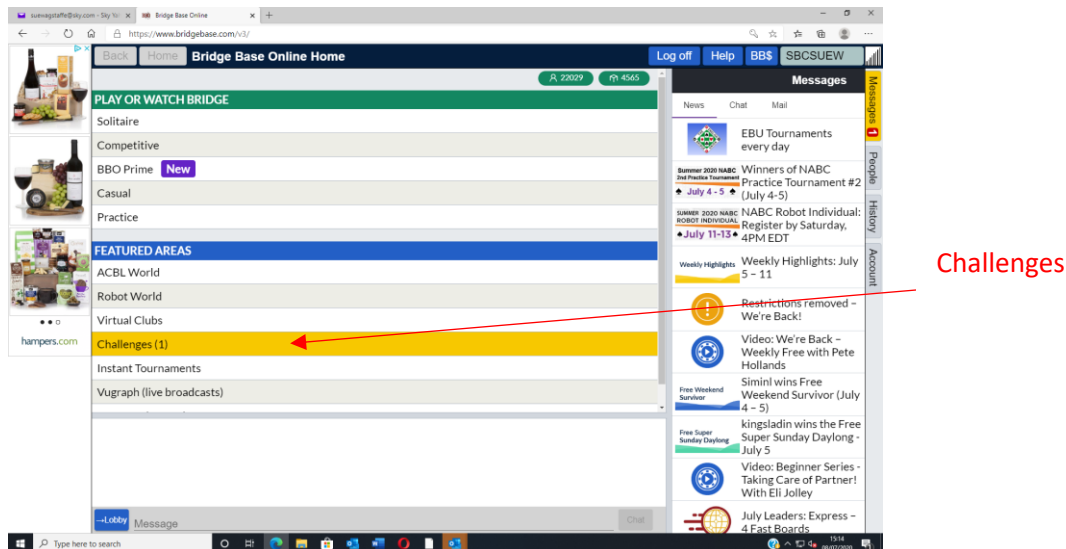

Click on this bar and at the top of the screen it will tell you who has challenged you. Click on that and it will invite you to accept the challenge and tell you how long you have to complete the challenge. (you can accept the challenge and choose to play it later).

If you don't want to play – then do not accept the challenge – as simple as that !